

## HOLD OPEN ARM MOUNTING INSTRUCTIONS

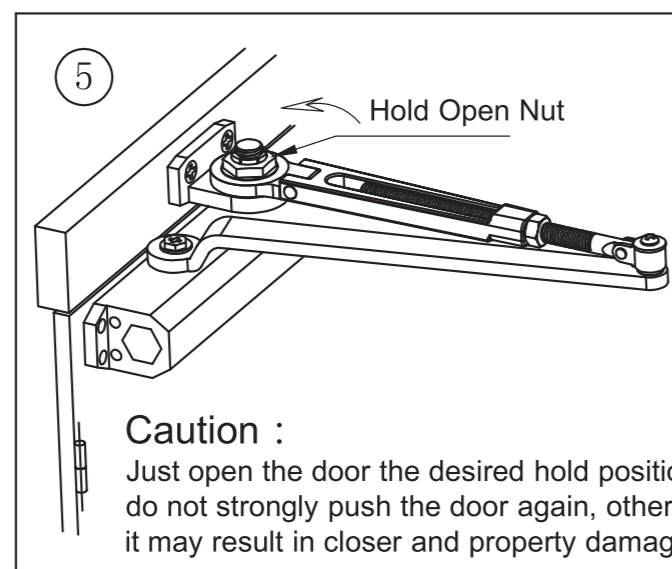
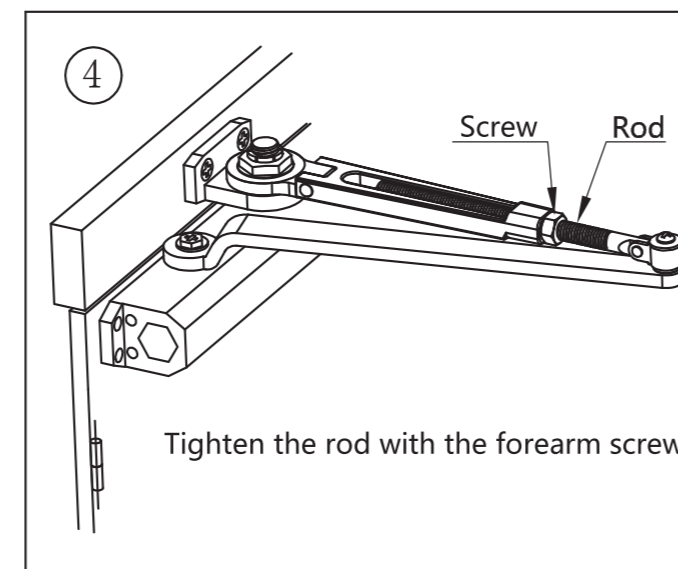
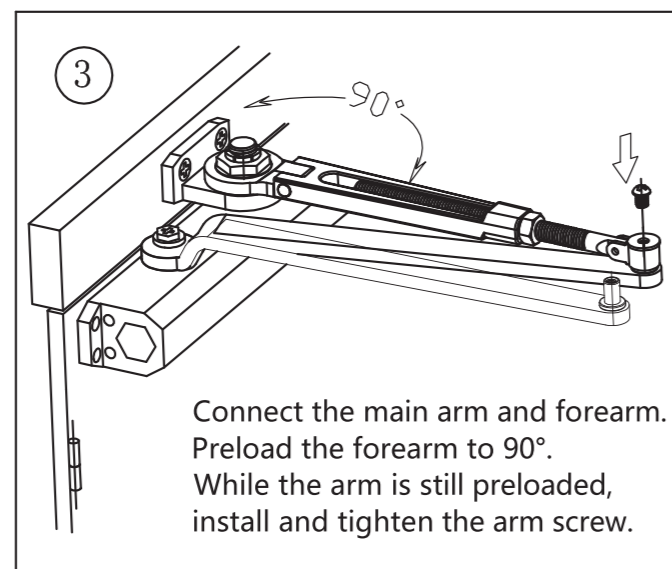
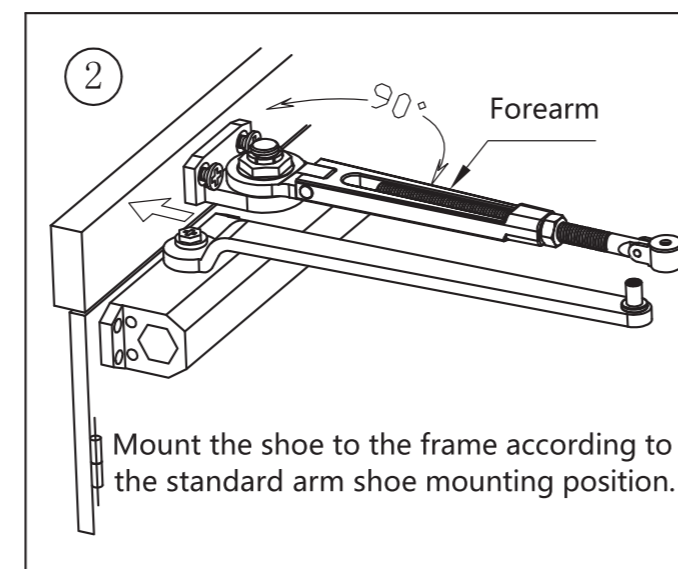
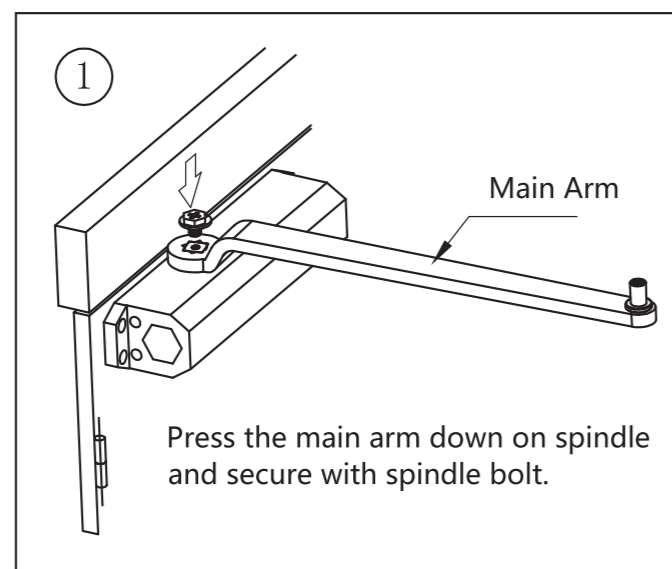

1. Loosen hold open nut
2. Open door to desired hold position and tighten hold open nut securely.

Note:  
1. Hold Open angle has been preset between 90° and 100°  
2. Hold open arm mounting position is the same with standard arm.

## HOLD OPEN ARM MOUNTING INSTRUCTIONS

Push Side - Right Hand shown, Left Hand opposite

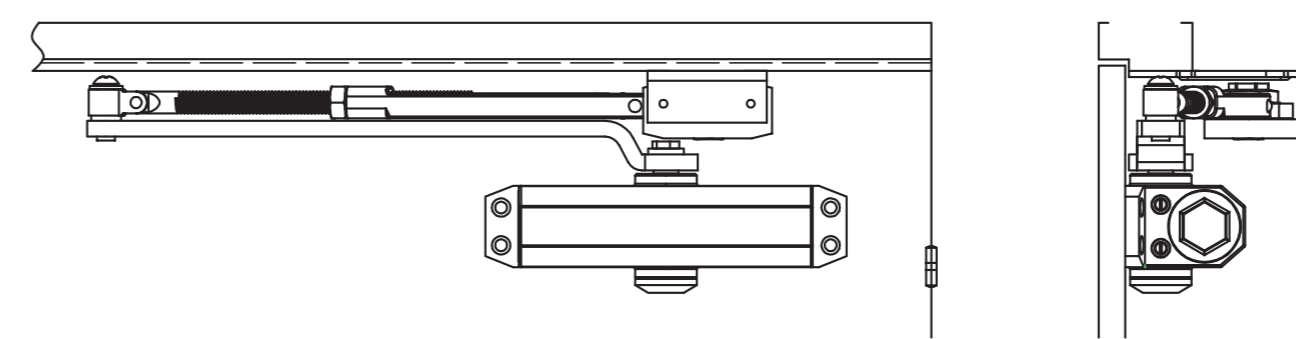

1. Fix the door closer body and PA shoe on door and frame separately per standard arm PA mounting instructions.
2. Fix the hold open arm shoe to PA shoe and tighten hold open nut securely (hold open nut upward, left hand opposite)
3. Preload main arm to be parallel with frame, and adjust the length of forearm to connect with main arm.

