

Installation Instructions

8800 & F-8800 Rim Device

Determine handing of door

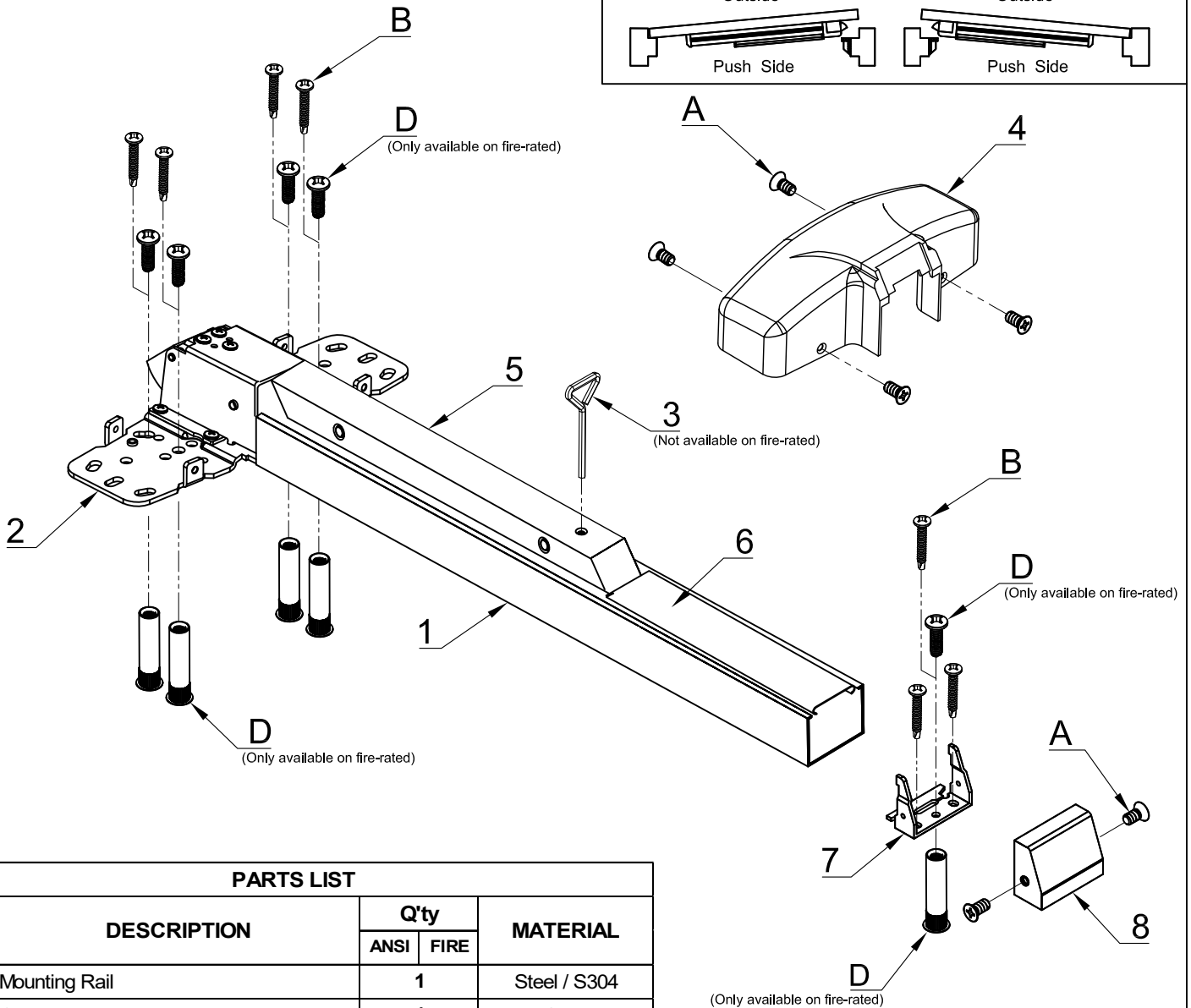
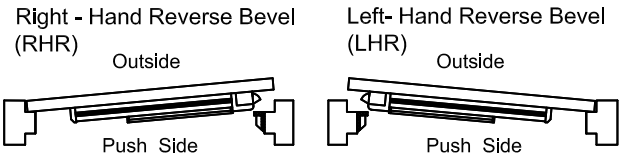

PARTS LIST

ITEM	DESCRIPTION	Q'ty		MATERIAL
		ANSI	FIRE	
1	Mounting Rail	1		Steel / S304
2	Chassis Assy	1		Steel
3	Dogging Hex Key	1	N/A	Steel
4	Head Cover	1		AL/Zinc/S304/Steel
5	Push Rail	1		Steel / S304
6	Sliding Cover	1		Steel / S304
7	Bracket	1		Steel
8	End Cap	1		Steel / S304
9	Strike	1		Steel
A	SM4x8 Long Flat Head Screws	6		S304
B	ST4.8x1-1/4" Long Pan Head TEK Screws	10	5	Steel
C	#10-24 UNC x 5/8" Long Pan Head Machine Screws	3		Steel
D	Sex Bolt (Include M6 x 1.0p x 20mm Long Pan Head Machine Screws with Sexnut)	N/A	5	Steel

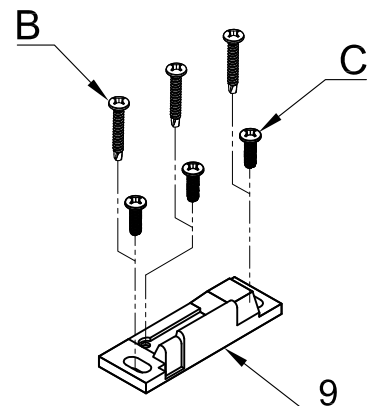

STEP 1: MARK CENTER LINES

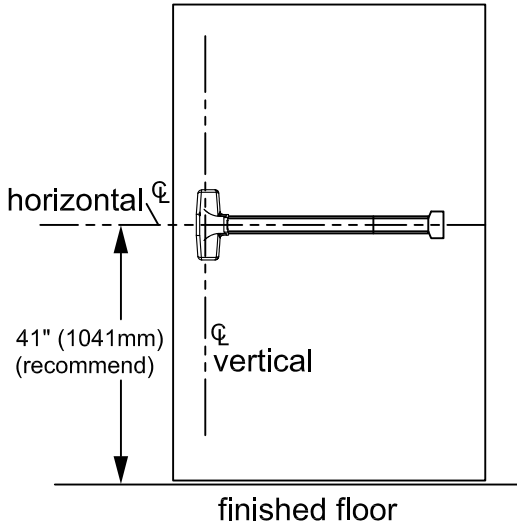

※ If required, add strike shim under strike for $\frac{3}{16}$ " (4.8mm) as dimension shown

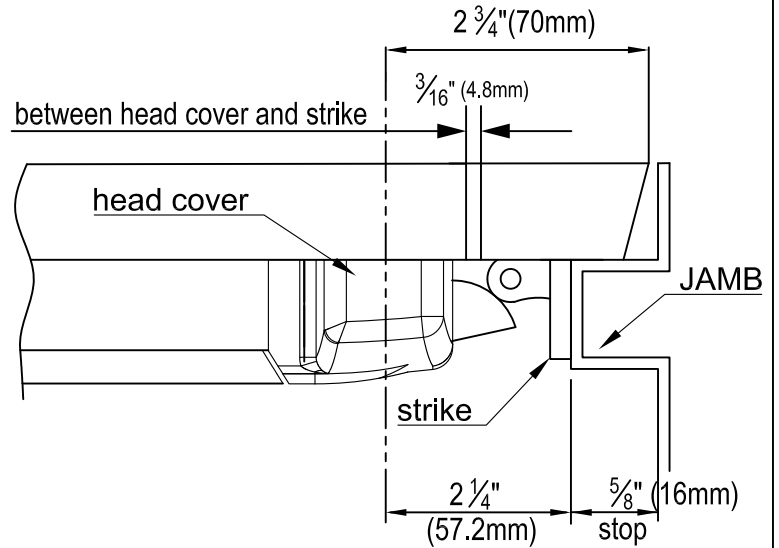

STEP 2: PREPARE INSTALLATION

※ RHR shown (LHR opposite)

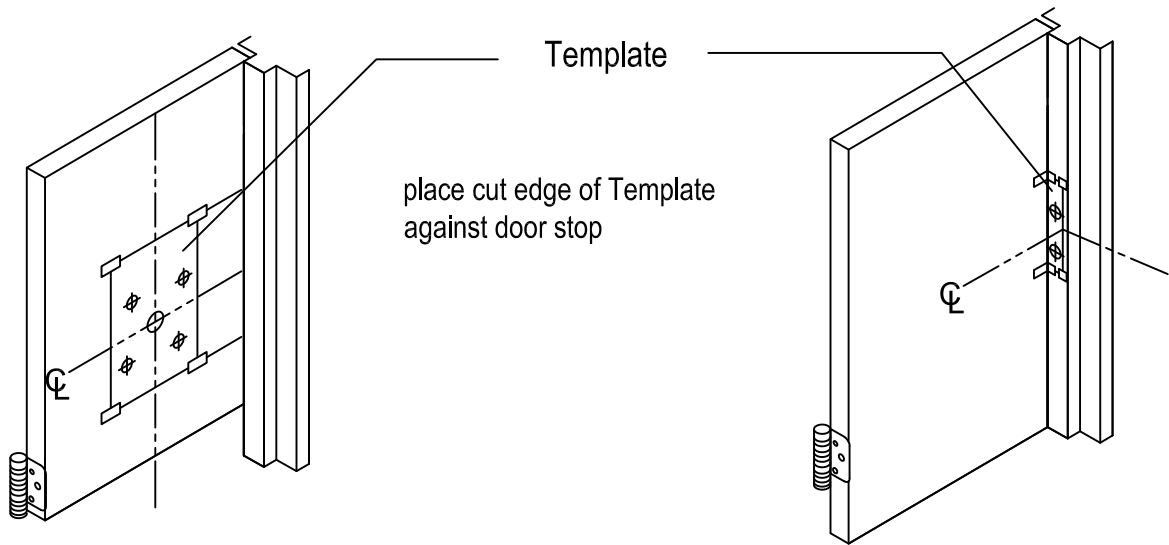

Notice 1 : Tail-piece length

Keep tailpiece $\frac{5}{16}$ "~ $\frac{1}{2}$ " (8~12.7mm) projected.

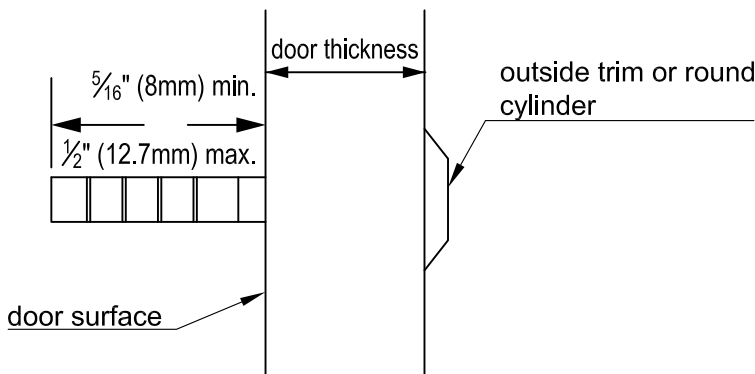

Notice 2: Dogging (For non fire-rated)

Press down the push rail, turn the dogging hex key clockwise or counterclockwise, then the device will change to "Passage" function.

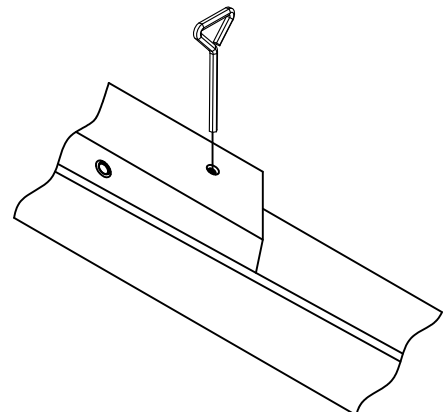

STEP 3: CUT DEVICE IF REQUIRED

3.1 Device length A must be at least $1\frac{1}{2}$ " (38mm) shorter than B

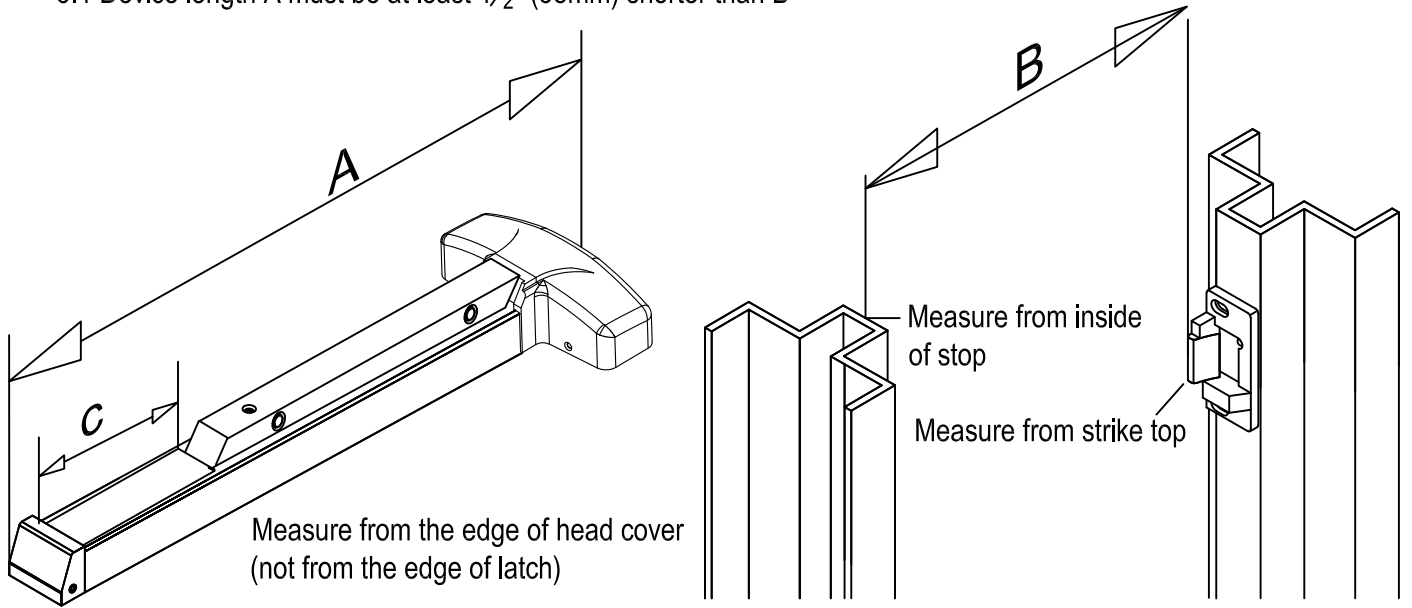

3.2 If required, cut length C, so A is at least $1\frac{1}{2}$ " (38mm) shorter than B.

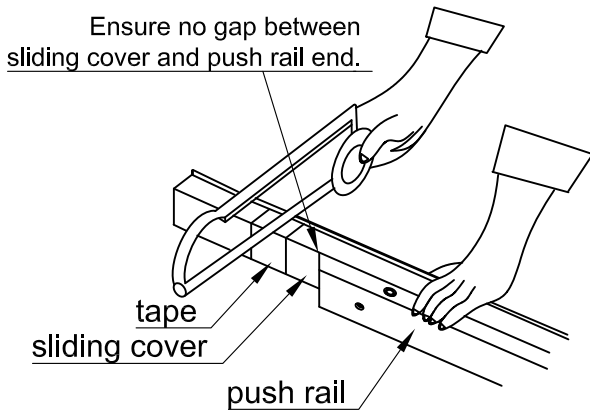

NOTE : the minimum length of the sliding cover must be 1"(25.4mm) or longer than length "C".

3.3 Standard Door Stop is $\frac{5}{8}$ " (15.9mm). Install $\frac{1}{8}$ " (3mm) strike shim if required.

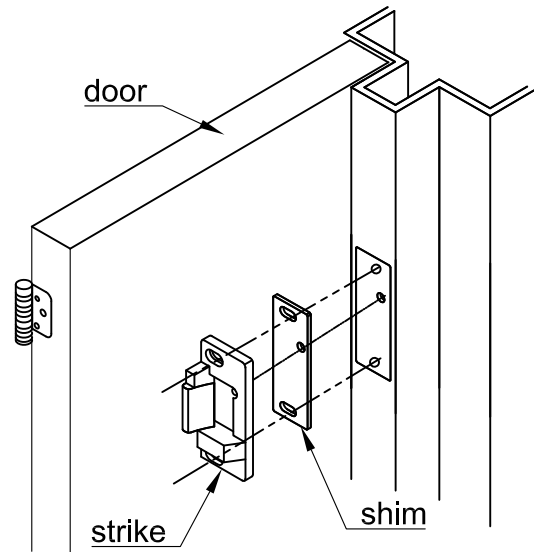

STEP 4 : INSTALL DEVICE

- 4.1 Take off head cover and put device horizontally at the door. Fix screws (B) on chassis but DO NOT tighten them at this step.
- 4.2 Install bracket with screw (B). Be sure to remain device being horizontal and then tighten all screws.
- 4.3 Install end cap & head cover.

- ※ for "FIRE RATED" :
please drill $\phi \frac{3}{8}$ " ($\phi 9.6\text{mm}$) hole for Sex Bolt (D)
- ※ for "NON FIRE-RATED" :
please use screw (B) directly

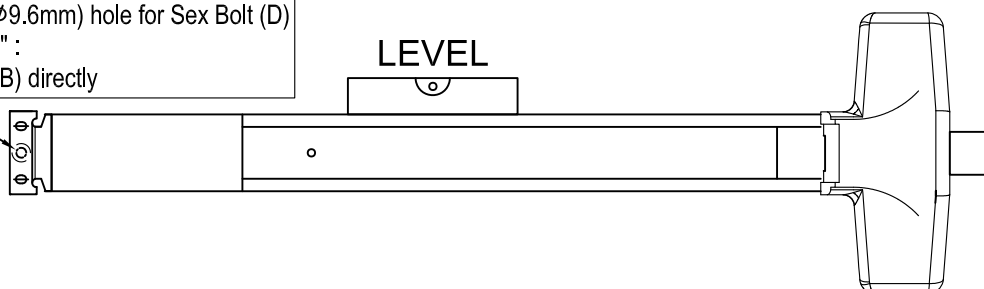

Apply TRIM + CHASSIS

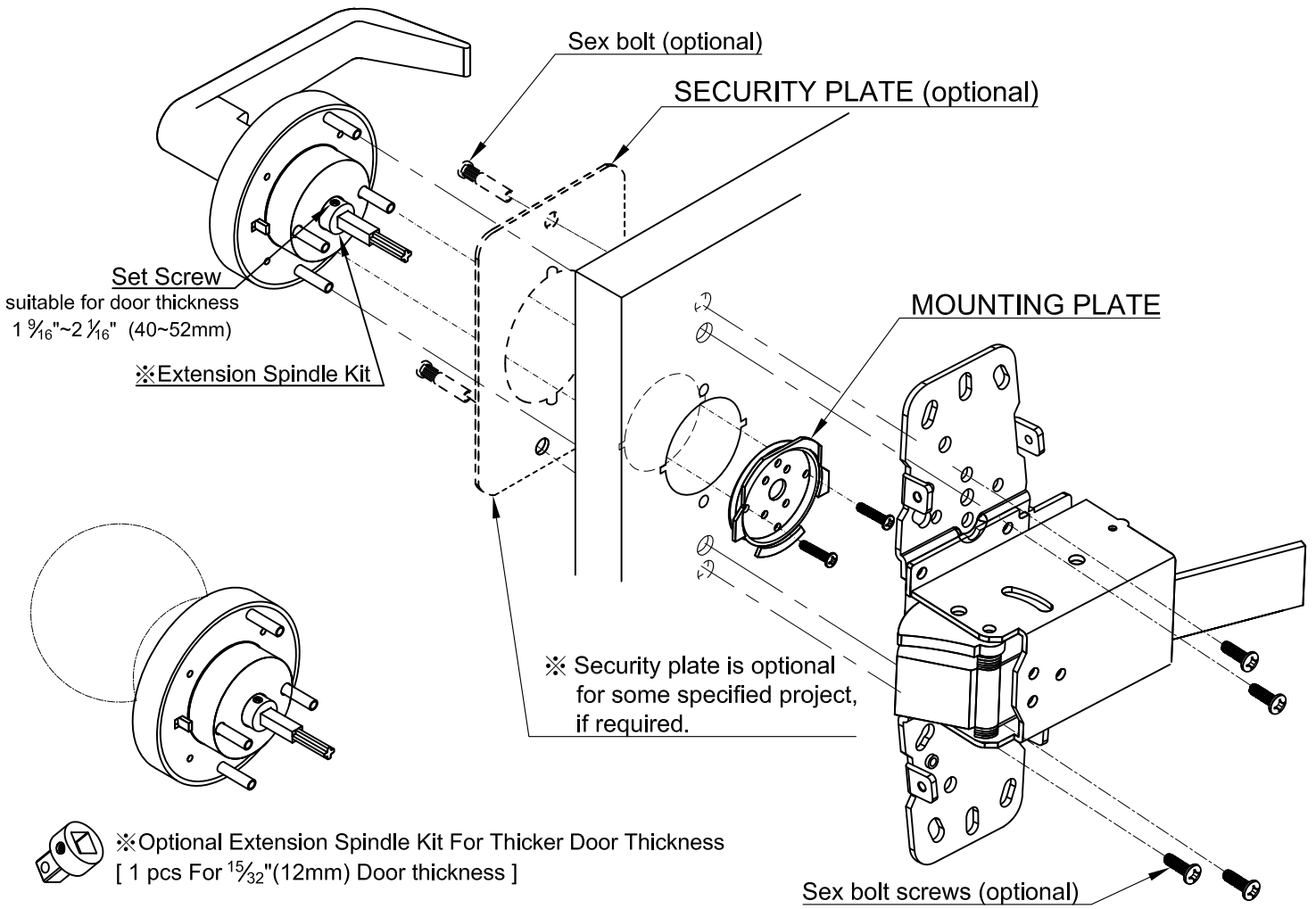

Thumbpiece trim

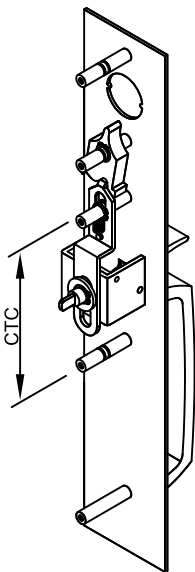

CTC = 4 $\frac{1}{4}$ " (108mm)

Pull trim

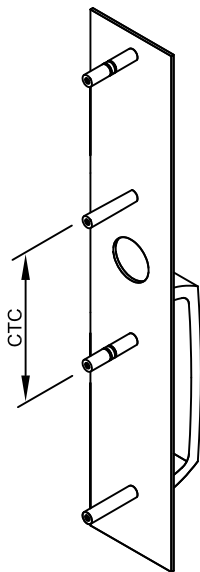

CTC = 4 $\frac{1}{4}$ " (108mm)

Pull trim

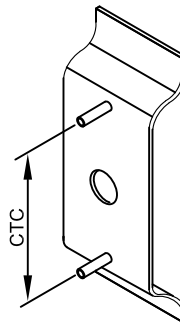

CTC = 3 $\frac{1}{2}$ " (89mm)

Trim with security plate

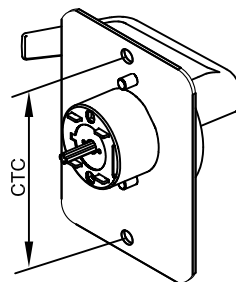

CTC = 4 $\frac{1}{4}$ " (108mm)

ESC lever trim

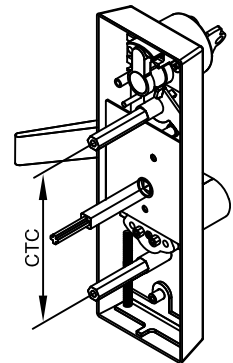

CTC = 4 $\frac{1}{4}$ " (108mm)

Trim w/o security plate

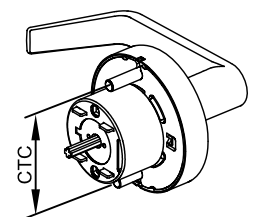

CTC = 2 $\frac{3}{4}$ " (70mm)

TEMPLATE

OF 8800 / F-8800 RIM DEVICE (1:1)

